

## DIGITAL CONVERTERS

## STRAIN-GAUGE EMBEDDED DIGITAL CONVERTERS

These digital converters convert the signal from a Wheatstone bridge (mV/V) into a standardised digital signal RS-232, RS-485 or USB



DIGITAL CONVERTER

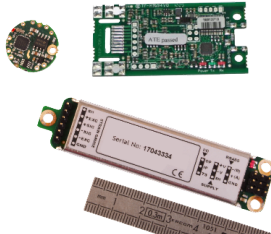

### Features

- o Very high resolution
- o Linearisation of transducer signal available
- o High transmission speed
- o Internal or external mounting depending on the size of the transducer
- o When external, rectangular box in aluminium (protection class IP65)

### Available option(s)

- temperature measurement with compensation of thermal drifts

### Application(s)

SENSY's digital converters are perfectly designed for the following applications:

- Connection of the load cell directly to a computer or a PLC,
- Digital linearisation and thermal compensation integrated in the transducer.

### Function(s)

- Scaling of output signal in measuring unit
- Easy connection to PC or PLC
- For USB-ASC: Self powered by the port

Specifications	RS232-ASC	RS485-ASC	RS485-MOD	USB-ASC	
Input range	$\pm 3$ mV/V	$\pm 3$ mV/V	$\pm 3$ mV/V	3 mV/V	-
Sensor excitation	4.5...5.25 VDC	4.5...5.25 VDC	4.5...5.25 VDC	5 VDC	-
Non-linearity error	$< \pm 0.003$	$< \pm 0.003$	$< \pm 0.003$	0.0025	% F.S.*
Impedance of Wheatstone bridge	320...5000	320...5000	320...5000	85...5000	ohm(s)
Baud rate	2.4...230 kbps	2.4...230 kbps	2.4...230 kbps	115...200 kbps	-
A/D converter	5000...66 000 div.***	5000...66 000 div.***	5000...66 000 div.***	50 000...200 000 div.***	-
Protocol	ASCII	ASCII	MODBUS	ASCII	-
Bandwidth	1...500	1...500	1...500	1...100	Hz
Service temperature range	-40...+85	-40...+85	-40...+85	-40...+85	°C
Temperature coefficient of the sensitivity	$< \pm 0.05$	$< \pm 0.05$	$< \pm 0.05$	0.005	% F.S./10°C
Temperature coefficient of zero signal	$< \pm 0.01$	$< \pm 0.01$	$< \pm 0.01$	0.004	% F.S./10°C
Power supply	5.6...12...18 VDC	5.6...12...18 VDC	5.6...12...18 VDC	USB	-
Consumption (max.)	60**	60**	60**	68**	mA

\*F.S. : Full Scale.

\*\* : with Wheatstone bridge of 350 ohms.

\*\*\* : according to reading frequency.

Specifications subject to change without notice.



ISO 9001 certified

DIGITAL CONVERTERS > STANDARD DIMENSIONS

**Internal mounting in transducer:**

- RS485-ASC
- RS485-MOD

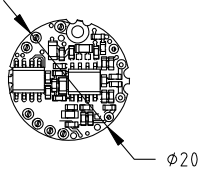

- USB-ASC

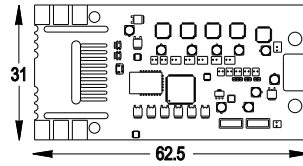

**External mounting in housing:**

- RS232-ASC
- RS485-ASC
- RS485-MOD

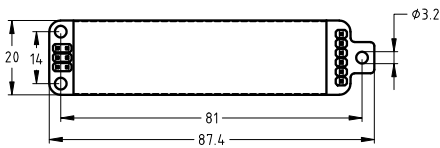

**Matching case:**

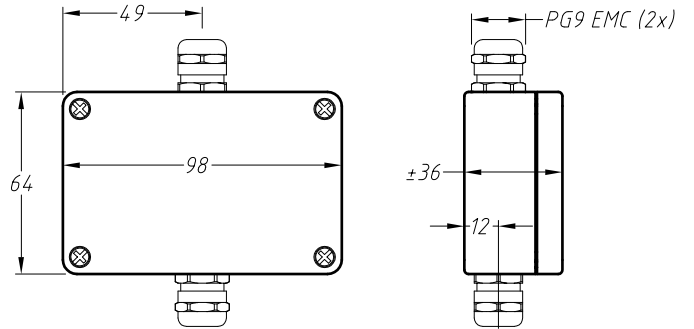

- USB-ASC

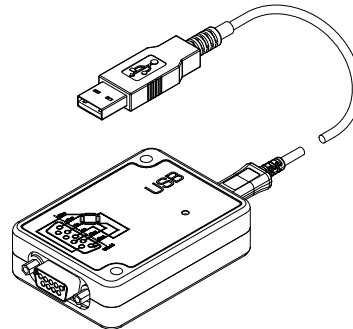
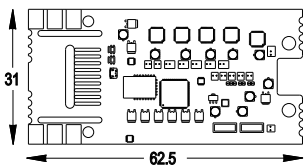

Dimensions in mm

**Terminals**

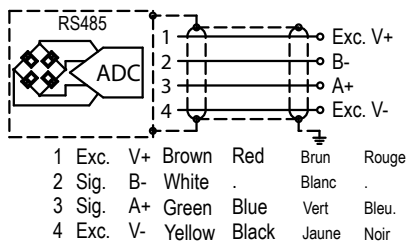

Shielding connected to housing connector  
Faradisation connectée au corps du connecteur

