

Small-sized single point load cells.



Model 2052 - 5 kg



Features

- o Designed for off-center load
- o Maximum platform size: 250x250 / 400x400 mm (depending on capacity)
- o Small sized
- o Material: anodised aluminium alloy
- o Protection class: IP54
- o Competitive price
- o Cable length: see drawing table - CL (other lengths available on request)
- o Easy to install

Most popular options



Application(s)

SENSY's load cells 2052 are perfectly designed for the following applications:

- Bench scales,
- Small hopper weighing,
- Filling, packaging and batching applications.

Capacities

2052: 2 - (3) - 5 - 10 - 20 - 30 - 40 - 50 - 100 - (150) - 200 kg

Specifications	A3	0.03 %	
Accuracy class	0.03 %** F.S.*	0.03% F.S.*	-
Combined error (non-linearity + hysteresis)	<± 0.03	<± 0.03	% F.S.*
Repeatability error	<± 0.015	<± 0.015	% F.S.*
Creep error over 30 min.	<± 0.03	<± 0.025	% F.S.*
Reference temperature	23	23	°C
Compensated temperature range	-10...+45	-10...+45	°C
Service temperature range	-30...+70	-30...+70	°C
Storage temperature range	-50...+85	-50...+85	°C
Temperature coefficient of the sensitivity	<± 0.05	<± 0.015	% F.S./10°C
Temperature coefficient of zero signal	<± 0.05	<± 0.023	% F.S./10°C
Nominal sensitivity	1.6...2.7	1.6...2.7	mV/V
Sensitivity tolerance	<± 0.2	<± 0.2	%
Input resistance	400 ± 10	400 ± 10	ohm(s)
Output resistance	350 ± 3	350 ± 3	ohm(s)
Insulation resistance (50 V)	> 5000	> 5000	Mohm(s)
Reference excitation voltage	10	10	VDC
Permissible nominal range of excitation voltage	3..12	3..12	VDC
Safe load limit	150	150	% F.S.*
Breaking load	>300	>300	% F.S.*
Permissible dynamic loading	60	60	% F.S.*
Static lateral force limit	100	100	% F.S.*

* F.S. : Full Scale.

** : except thermal drifts.

Specifications subject to change without notice.



ISO 9001 certified

2052 > STANDARD DIMENSIONS

2052-A

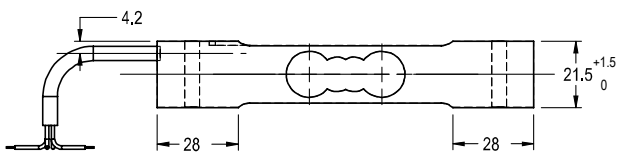

2052-B

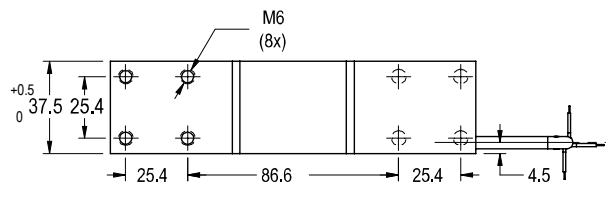
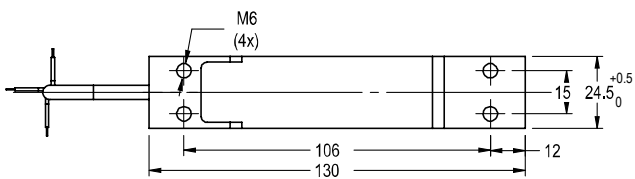
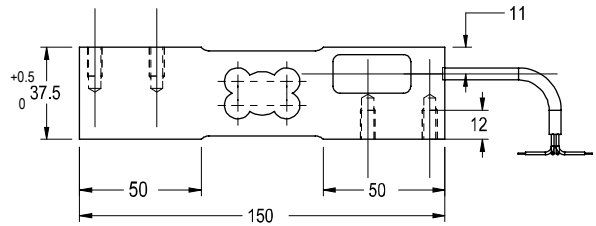

Ref. Item	Capacities	Max. Platform Size (mm)	CL (m)	Weight (kg)
2052-A	2 - 40 kg	250 x 250	0.5	0.15
2052-B	50 - 200 kg	400 x 400	1.5	0.52

→ Other capacities and dimensions available on request

Dimensions in mm

Accessories

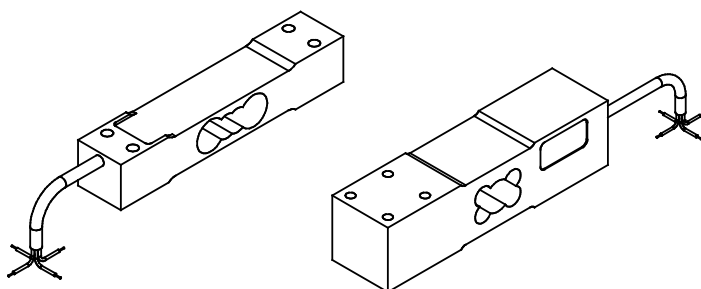

Wiring

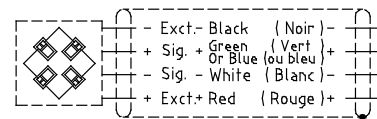

Standard : Cable screen not connected to transducer
Faradisation non connectée au capteur

Load direction

